

NOTICE TO THE PUBLIC
Community Development Block Grant Program

Passaic County

Passaic County New Jersey proposes to amend the FY 2018 Action Plan for the Community Development Block Grant (CDBG) Program. The Borough of Hawthorne is terminating the Public Infrastructure project to mill and pave and install ADA curb ramps in North 10th Street and Irvington Avenue originally funded under the CDBG FY 2018 Action Plan. The original proposed project will be extensively delayed due to new gas line installation by the local utility. Therefore, the Borough of Hawthorne will utilize the CDBG FY 2018 grant allocation of \$80,000 to install ADA ramps in several locations throughout the Borough.

A Public Meeting to address any questions about the Substantial Amendment will be held on February 7, 2019 at 4 p.m. at the following address:

PASSAIC COUNTY DEPARTMENT OF PLANNING AND ECONOMIC DEVELOPMENT
930 Riverview Drive, Totowa, NJ, Suite 250

Copies of the amendment are available for public inspection and review at the following locations for a thirty-day period from January 23, 2019 to February 22, 2019.

PASSAIC COUNTY DEPARTMENT OF PLANNING AND ECONOMIC DEVELOPMENT
930 Riverview Drive, Totowa, NJ, Suite 250

OFFICE OF THE MUNICIPAL CLERK in
BOROUGH of HAWTHORNE
AND

<http://www.passaiccountynj.org>

Any individuals interested on commenting on the Substantial Amendment may do so in writing to Passaic County Department of Planning and Economic Development, 930 Riverview Drive, Suite 250, Totowa, NJ 07512. All comments received by 4:00 pm on February 22, 2019 will be considered. The Freeholders will meet on February 26, 2019 to consider the amendment. La información será proporcionada en español a petición.

**Table 3
Consolidated Plan Listing of Projects**

Applicant's Name Passaic County

Priority Need
Infrastructure

Project Title
Borough of Hawthorne – Curb Ramps

Project Description
Installation of Curb ramps at various locations in the borough – see attached map.

Objective category: Suitable Living Environment Decent Housing Economic Opportunity
Outcome category: Availability/Accessibility Affordability Sustainability

Location
Hawthorne Borough – see attached.

Goal Number 3	Project ID	Funding Sources: CDBG 80,000 ESG HOME HOPWA Total Formula 80,000 Prior Year Funds Assisted Housing PHA Other Funding Total 80,000
HUD Matrix Code 03L	CDBG Citation 570.201(c)	
Type of Recipient Local Government	CDBG National Objective 570.208(a)(ii) Limited Clientele Presumed Benefit	
Start Date (mm/dd/yyyy) 02/20/2019	Completion Date (mm/dd/yyyy) 8/31/2020	
Performance Indicator 01 People	Annual Units 840 People	
Local ID	Units Upon Completion	

The primary purpose of the project is to help: the Homeless Persons with HIV/AIDS Persons with Disabilities Public Housing Needs

WAGNER PLACE / REID PLACE / NORMA TERRACE / MIDLAND AVENUE

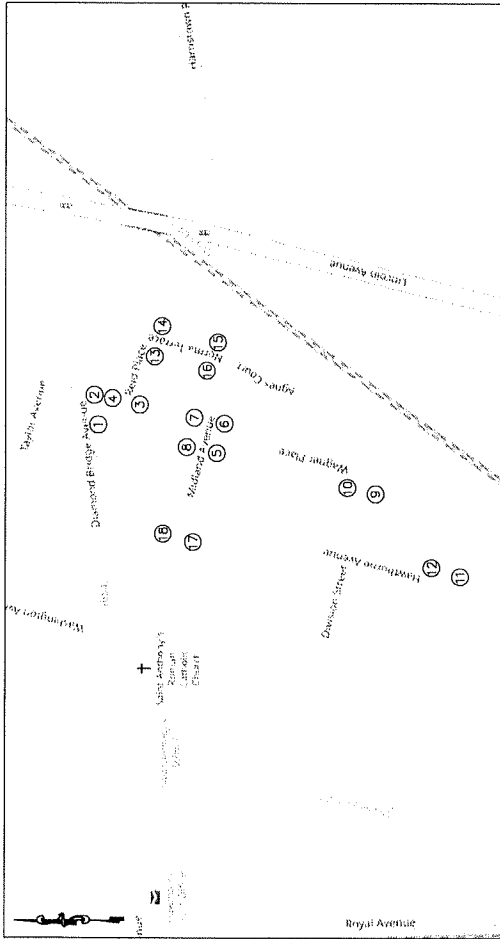

KENWOOD ROAD / CIDER MILL ROAD

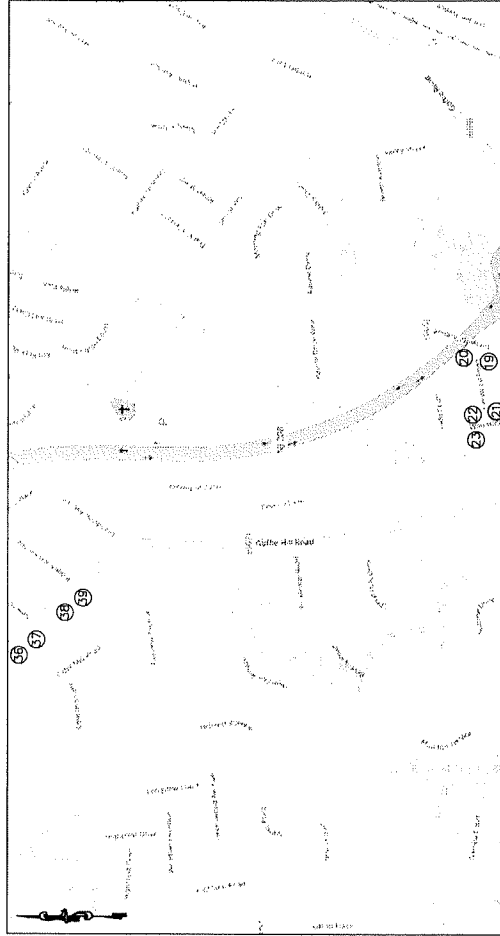

PRESCOTT AVENUE

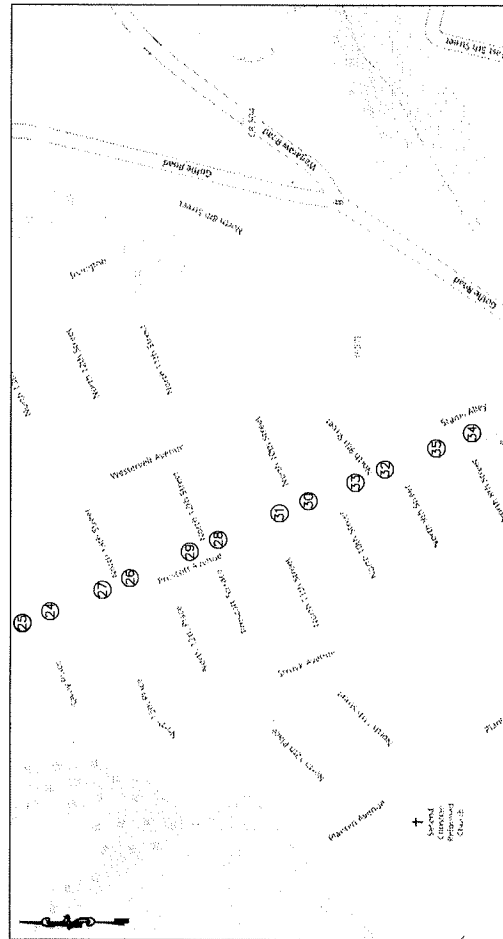

VREELAND AVENUE / SEVENTH AVENUE

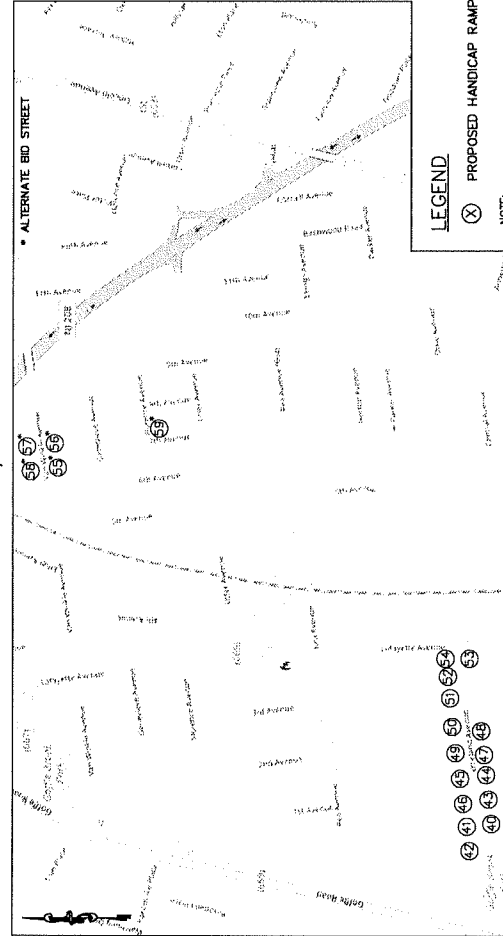

LEGEND

⊗ PROPOSED HANDICAP RAMP

NOTE:
MAPS COURTESY OF OPEN STREET MAPS, 2019

2019 CDBG HAWTHORNE HANDICAP RAMP
IMPROVEMENTS PROGRAM
PROJECT LOCATION MAPS
BOROUGH OF HAWTHORNE
PASSAIC COUNTY, NEW JERSEY
DRAWN BY: REF. CHECKED BY: CH. SCALE: DATE: 1/18/19
DATE PLOTTED: HW-770-HCR-LM SHEET 1 OF 1

BOSWELL ENGINEERING
ENGINEERS - SURVEYORS - PLANNERS - SCIENTISTS
300 W. LINDEN AVENUE, SUITE 200
LINDEN, NJ 07036
TEL: (201) 641-0770 FAX: (201) 641-1831
N.J. CERTIFICATE OF AUTHORIZATION NO. 246A00068000

NO.	DATE	DESCRIPTION	BY	DATE	BY

2019 CDBG HAWTHORNE HANDICAP RAMP IMPROVEMENTS PROGRAM

HANDICAP RAMP LOCATION BREAKDOWN

Job No. HW-770

Date: 1/18/19

Location Map I.D. No.	Intersection	Number of Ramps (Detectable Warning Surfaces)
1	Wagner Place and Diamond Bridge Avenue (SW Corner)	1
2	Wagner Place and Diamond Bridge Avenue (SE Corner)	1
3	Wagner Place and Reid Place (SE Corner)	1
4	Wagner Place and Reid Place (NE Corner)	1
5	Wagner Place and Midland Avenue (SW Corner)	2
6	Wagner Place and Midland Avenue (SE Corner)	2
7	Wagner Place and Midland Avenue (NE Corner)	2
8	Wagner Place and Midland Avenue (NW Corner)	2
9	Wagner Place and Division Street (SW Corner)	1
10	Wagner Place and Division Street (NW Corner)	1
11	Wagner Place and Hawthorne Avenue (SE Corner)	1
12	Wagner Place and Hawthorne Avenue (NE Corner)	1
13	Reid Place and Norma Terrace (SW Corner)	1
14	Reid Place and Norma Terrace (SE Corner)	1
15	Norma Terrace and Midland Avenue (NE Corner)	1
16	Norma Terrace and Midland Avenue (NW Corner)	1
17	Midland Avenue and Hawthorne Avenue (SE Corner)	1
18	Midland Avenue and Hawthorne Avenue (NE Corner)	1
19	Kenwood Road and Lafayette Avenue Extension (SW Corner)	1
20	Kenwood Road and Lafayette Avenue Extension (NW Corner)	1
21	Kenwood Road and Woodside Avenue (SE Corner)	1
22	Kenwood Road and Woodside Avenue (NE Corner)	2
23	Kenwood Road and Woodside Avenue (NW Corner)	1
24	Prescott Avenue and North 14th Street (SE Corner)	1
25	Prescott Avenue and North 14th Street (NE Corner)	1
26	Prescott Avenue and North 13th Street (SE Corner)	1
27	Prescott Avenue and North 13th Street (NE Corner)	1
28	Prescott Avenue and North 12th Street (SE Corner)	1
29	Prescott Avenue and North 12th Street (NE Corner)	1
30	Prescott Avenue and North 10th Street (SE Corner)	1
31	Prescott Avenue and North 10th Street (NE Corner)	1
32	Prescott Avenue and North 9th Street (SE Corner)	1
33	Prescott Avenue and North 9th Street (NE Corner)	1
34	Prescott Avenue and North 8th Street (SE Corner)	1
35	Prescott Avenue and North 8th Street (NE Corner)	1
36	Cider Mill Road and Goffle Hill Road (SW Corner) (1)	1
37	Cider Mill Road and Goffle Hill Road (SE Corner) (1)	1
38	Cider Mill Road and Goffle Hill Road (SW Corner) (2)	1
39	Cider Mill Road and Goffle Hill Road (SE Corner) (2)	1

2019 CDBG HAWTHORNE HANDICAP RAMP IMPROVEMENTS PROGRAM

HANDICAP RAMP LOCATION BREAKDOWN

Job No. HW-770

Date: 1/18/19

Location Map I.D. No.	Intersection	Number of Ramps (Detectable Warning Surfaces)
40	Vreeland Avenue and Bamford Avenue (SE Corner)	1
41	Vreeland Avenue and Bamford Avenue (NE Corner)	2
42	Vreeland Avenue and Bamford Avenue (NW Corner)	1
43	Vreeland Avenue and Parmelee/First Avenue (SW Corner)	1
44	Vreeland Avenue and Parmelee/First Avenue (SE Corner)	1
45	Vreeland Avenue and Parmelee/First Avenue (NE Corner)	1
46	Vreeland Avenue and Parmelee/First Avenue (NW Corner)	1
47	Vreeland Avenue and Buena Vista/Second Avenue (SW Corner)	1
48	Vreeland Avenue and Buena Vista/Second Avenue (SE Corner)	2
49	Vreeland Avenue and Buena Vista/Second Avenue (NW Corner)	2
50	Vreeland Avenue and Buena Vista/Second Avenue (NE Corner)	1
51	Vreeland Avenue and Third Avenue (NW Corner)	1
52	Vreeland Avenue and Third Avenue (NE Corner)	1
53	Vreeland Avenue and Lafayette Avenue (SW Corner)	1
54	Vreeland Avenue and Lafayette Avenue (NW Corner)	1
55	Seventh Avenue and Van Winkle Avenue (SW Corner)	1
56	Seventh Avenue and Van Winkle Avenue (SE Corner)	1
57	Seventh Avenue and Van Winkle Avenue (NE Corner)	1
58	Seventh Avenue and Van Winkle Avenue (NW Corner)	1
59	Seventh Avenue and Florence Avenue (SE Corner)	1

Total Number of Ramps

67 Ramps (60.3 S.Y.)



BOROUGH OF HAWTHORNE

County of Passaic
State of New Jersey



RESOLUTION NO. 28-19

Resolution, Introduced by Council Person Mele Date: January 16, 2019

Resolution Requesting Reallocation of CDBG Funds

WHEREAS, the County of Passaic previously awarded to the Borough of Hawthorne the sum of \$80,000 in funds by way of CDBG Grant so as to allow for the repaving of a portion of North 10th Street, Stam's Alley and Irvington Street, all identified by the Borough in its request for funding as its First Priority Project; and

WHEREAS, subsequent to the award, the County of Passaic advised that Stam's Alley, being a dead-end street, was not eligible for inclusion in the program funding available through CDBG. In addition, PSE&G advised that it was about to undertake, in 2019 or 2020, extensive gas main and gas line replacement in the very area in North 10th Street that was to be repaved, making current plans to repave said road section impractical and unwise; and

WHEREAS, the Municipal Council of the Borough of Hawthorne, at the recommendation of the Administration, has concluded that it should seek a reallocation of the CDBG Grant funds awarded by the County of Passaic to its Second Priority Project, identified at the time of its funding request, the replacement of sidewalk curb ramps for ADA accessibility purposes at various locations throughout the Borough;

NOW, THEREFORE, BE IT RESOLVED, by the Municipal Council of the Borough of Hawthorne, that it requests the County of Passaic reallocate funding provided by way of CDBG Grant to Hawthorne's identified First Priority Project, the repaving of roads as set forth herein, to its Second Priority Project, the replacement of sidewalk curb ramps for ADA purposes at various locations throughout the Borough.

CERTIFICATION

I, Lori DiBella, Borough Clerk of the Borough of Hawthorne, County of Passaic, State of New Jersey, do hereby certify this copy of R 28-19 to be a true copy as adopted by the Municipal Council on Jan 16, 2019
L. DiBella
Lori DiBella, RMC, CMC, Borough Clerk

Name	Motion	Second	Yes	No	Abstain	Absent
Bennett			X			
Bertollo		X	X			
Lane			X			
Matthews			X			
Mele	X		X			
Sinning						X
Wojtecki			X			

Frank E. Matthews
Frank E. Matthews, Council President

L. DiBella
Lori DiBella, RMC, CMC, Borough Clerk

Factual Content Certified by

Approved as to form and legality on basis of facts set forth

Name / Title / Date

[Signature]
Borough Attorney

1/16/19
Date